

Geck®

Manual for transportation trolleys





J.D. Geck GmbH

Grünwiese 28

58762 Altena

Telephone: +49 2352 542 0

Fax: +49 2352 542 138

Email: geck@geck.de

Internet: www.geck.de

The copyright for this manual is held by J.D. Geck GmbH.

Geck®

Contents

Table of contents	03/04
--------------------------------	--------------

1	Warranty Conditions	05
2	Safety notes	06
2.1	DIN 8472-1 ; GS mark	06
2.2	General safety notes	06
2.3	Summary.....	07
2.4	Proper use	07
2.5	Forbidden uses.....	08
2.6	Areas of use	08
3	Description	09
3.1	Geck GD4 trolley	09
3.2	Geck GD5 trolley	10
3.3	Geck GM 2/2 trolley	11
3.4	Geck GM4 trolley	12
4	Accessories	13
4.1	Addition of accessories from other manufacturers to Geck trolleys	13
5	Putting into use	14
5.1	Notes when putting into use	14
5.2	Providing the trolley for use	14
5.3	Safety instructions for shop personnel	14
6	Moving pavements or ramps	15
7	Operating the trolley	15
7.1	Extracting the trolleys	15
7.2	Using the trolleys	15
7.3	Returning the trolleys	16
8	Collecting and moving the trolleys	16
8.1	Manually collecting and moving	16
8.2	Collecting and moving with the assistance of machines and aids.....	16

Geck®

Contents

9	Maintenance and inspection of trolleys.....	17
9.1	Cleaning the trolleys	17
9.2	Inspecting the trolleys	17/18
10	Applied norms	18
11	Appendix	18
11.1	Checklist	18/19
12	Assembly, disassembly, replacing of parts.....	20
12.1	Replacing the castors	20
12.2	Replacing the fixed castors.....	20
12.2.1	Lockable castor	21
12.3	Replacing the handle	22
12.4	Replacing the lock	23
12.5	Replacing the rack	24
12.6	Replacing the bumper	25
12.7	Replacing in general	25
13	Disposal	25
14	Returns	26-28
Notes	29
Service addresses	30



1 Warranty Conditions

Each shopping and transportation trolley will be reviewed by the company J.D. Geck GmbH with high diligence before delivery and subject to final inspection. If there is a reason for complaint in spite of everything, our approach is as follows.

If not otherwise contractually agreed, the warranty period starts with the date of delivery and expires at the end of 24 months.

The defects observed have to be reported to the company J.D. Geck GmbH within 14 days of inspection, with the help of your completed return form.

The warranty covers defects which are verifiable due to improper materials or workmanship faults.

The costs occurred by fault correction, as well as related transport and installation costs, are covered by the company J.D. Geck GmbH. Further claims are excluded.

Faulty parts, which get replaced, have to be returned into the property of the company J.D. Geck GmbH. For the newly inserted parts a new 24-month warranty is granted. However, these repairs do not let restart the warranty period for the entire product.

Any repairs or services have to be executed by the company J.D. Geck GmbH or by authorised specialists. In case of inobservance to comply the complete warranty cannot be assumed.

In case of inobservance to follow the product instructions, inappropriate or improper use, faulty installation (by third parties) or damage caused by a foreign plot, no claim for warranty exists.

2 Safety notes

2.1 DIN 8472-1 ; GS mark

Our transportation trolleys are manufactured according to the specifications of the standard DIN 8472-1. During the production these specifications strictly get observed in all our models. You can therefore be assured that our transportation trolleys at any time comply with the requirements of DIN 8472-1 and comply at all times the same standard.

Please note!

Our GS marks shall apply to the TÜV (Technical Inspection Agency) approved transportation trolleys whose standard is defined for each GS mark. If a transportation trolley deviates from the standard due to modifications, the certification expires and must be re-applied with costs.

2.2 General safety notes

- Geck trolleys may only be used according to their intended purpose.
- Damaged or defective trolleys may not be used – they must immediately be removed from service and, if need be, repaired by an authorised specialist.
- Functional and safety checks should be carried out regularly and documented, see 8.2.
- Read the manual carefully before putting into service.
- Risks of injury and risks for customers and other passers-by cannot be excluded.
- Babies and small children may not be transported on the platform.
- Lines of trolleys may only be moved at walking pace by two people, one at the head and one at the tail of the line.
- Devices for moving trolleys may only be employed in agreement with J.D. Geck GmbH. The instructions of the manufacturer must be observed.
- In the event of subsequent modifications to the trolley (e.g. by the addition of accessories), the liability of J.D. Geck GmbH expires.
Exception: Conversions made by J.D. Geck GmbH or a specialist authorised by them
- The regulations of authorities and professional unions must be observed along with local construction and safety regulations.

2.3 Summary

The Geck trolleys are particularly well suited to heavy tasks.

Transporting bulky and heavy goods securely – in the shop, to the check-out, in the car park, to the car. Geck trolleys make things easy and convenient for your customers. Stable tube frames, water-proof bonded wood panels, robust castors and ergonomic handles - all trolley are able to prove their daily worth thanks to the high quality of materials and manufacturing.

In order to ensure that the goods you sell can be transported with the trolleys you provide without risks, check your product range regularly. Pay particular attention to the weight specifications that may be loaded into the trolleys. An information plate on the trolley indicates the loading options. Geck will not accept liability if this is not observed.

You can ensure safe use of the trolleys by regularly making your staff aware of the correct use of trolleys and asking them to keep their eyes open and to instruct customers in the event of incorrect use.

It is also necessary to carry out regular checks of the trolleys in order to be able to immediately complete repairs and maintenance work.

2.4 Proper use

Geck trolleys are designed for use in self-service stores and construction stores.

They are designed only for the transportation of purchased items.

2.5 Forbidden uses

- For safety reasons, babies, children and animals may not be transported on the loading platform of the trolley.
- Geck trolleys may not be tipped, lifted or carried.
- The trolley should not be pushed away carelessly nor permitted to roll down ramps; instead push in a controlled manner.

2.6 Areas of uses

- Geck trolleys are designed for use indoors in self-service stores and construction stores and in the car parks attached to such.
- Geck trolleys may only be used on flat surfaces.
- Public pavements and roads should be free of trolleys.
- Geck trolleys are **not** suitable for use on escalators.
- Geck trolleys may **only** be used on moving pavements/ramps with the castors intended for such.
- The regulations of professional unions are to be observed.
- The local construction and safety regulations are to be observed.

3 Description

3.1 Geck GD4 trolley

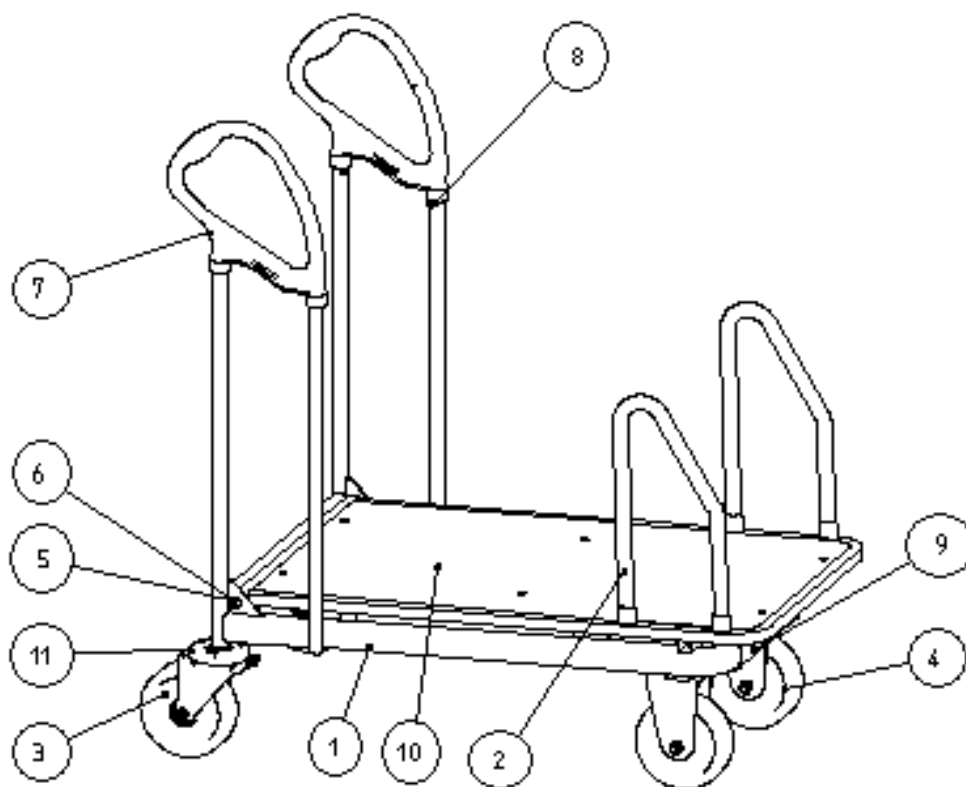

1. Basic frame without accessories
2. Base butterfly
3. Steering castor Ø160mm
4. Fixed castor Ø160mm
5. Fillister head screw
6. Base butterfly storage
7. Handle, round tube version
8. Tapping screw
9. Buffer – C-shaped profile
10. Wooden platform (plywood panel)
11. Repulsion ring for castors

3.2 Geck GD5 trolley

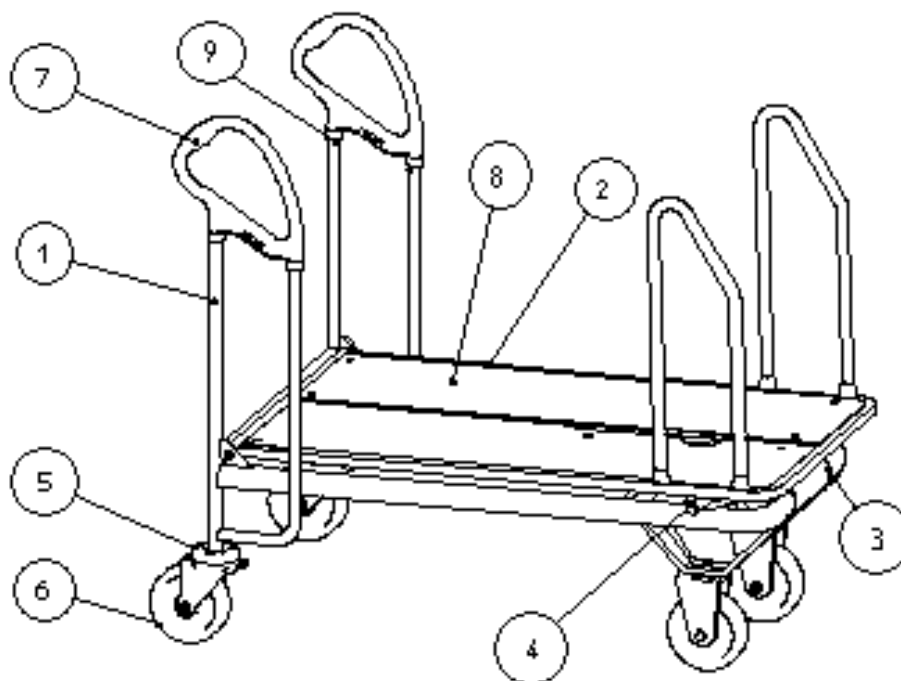

1. Basic frame
2. Base butterfly
3. Buffer – C-shaped profile
4. Gliders for RE tube
5. Repulsion ring
6. Steering castor Ø160mm
7. Handle, round tube version
8. Wooden platform (plywood panel)
9. Tapping screw

3.3 Geck GM 2/2 trolley

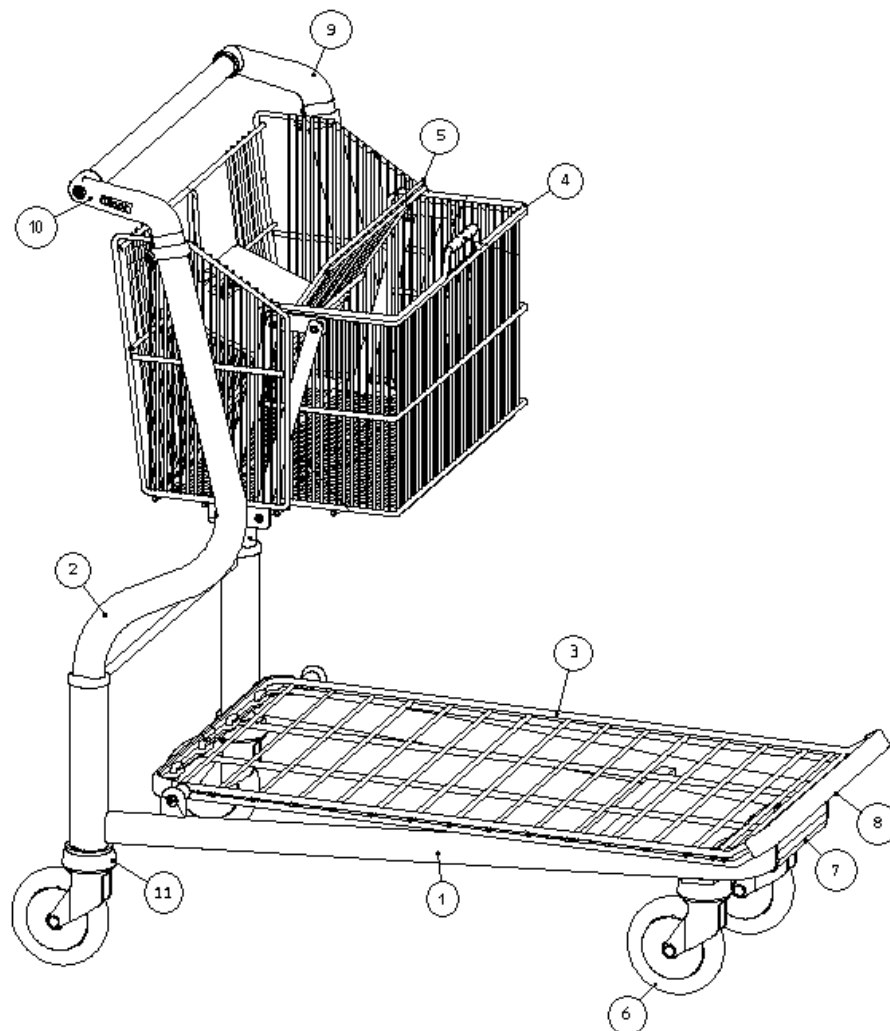

1. Chassis
2. Handle bar
3. Floor mesh
4. Basket
5. Child seat flap
6. Castor
7. Buffer
8. Bumper
9. Left handle
10. Right handle
11. Repulsion ring

3.3 Geck GM 4 trolley

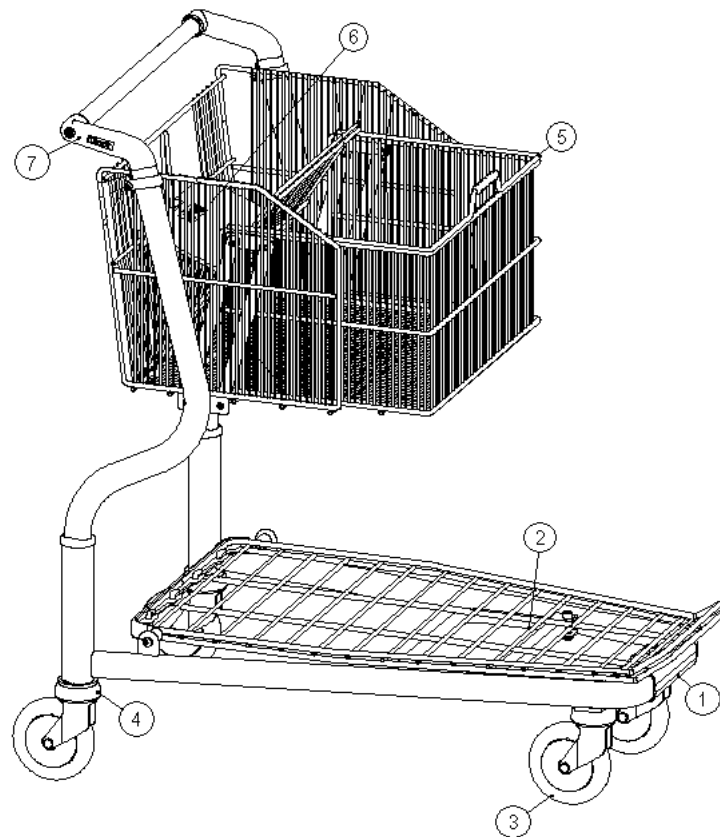

1. Base frame
2. Wire or wooden platform
3. Castors
4. Repulsion ring
5. Basket
6. Child seat
7. Handle

4 Accessories

1. Coin deposit system

Coin deposit system with coin slot, various versions possible

2. Side bar for panel transport

To secure bulky, long panels

3. Castors

Possible variations: 2 x fixed and 2x steering castors (Ø 160mm) /

4 x steering castors (Ø 125mm)

4. Advertising panels

At the side on the handle bars.

5. Flag pole

6. Wire basket for small items

4.1 Addition of accessories from other manufacturers to Geck trolleys

- This may only be carried out in agreement with the manufacturer.
- For any subsequent additions to Geck trolleys the prescribed standard must be maintained and the instructions of the manufacturer must be observed.
- When subsequently adding accessories, the product liability of the manufacturer expires.

5 Putting into use

5.1 Notes when putting into use

- Check each trolley for damages before making it available to customers
- Instruct your staff on the safe use of trolleys and the instruction of the end customers
- Ensure that the aisles offer sufficient space to turn the trolleys without damaging the goods or the furnishings
- Modified or defective trolleys must be immediately removed from use

5.2 Providing the trolley for use

Geck trolleys are delivered ready-to-use.

Slot the shopping trolleys together either in the parking box or the start of line station.

5.3 Safety instructions for shop personnel

The personnel must be trained in the safe handling of the trolleys.

All members of staff must be in a position to offer customers advice:

- ! When babies or children are sitting on the trolley
- ! When customers walk away from the trolley leaving it unattended
- ! When the trolley is not loaded correctly or is overloaded
- ! When customers attempt to use a moving pavement/ramp with trolleys that are unsuitable for such

We recommend that the information above is passed on to personnel in writing.

6 Moving pavements or ramps

The special castors must be used if the trolleys are to be used on moving pavements/ramps. These are precisely coordinated for the pavement/ramp.

The overall responsibility for safe use of Geck trolleys, in accordance with the applicable laws and standards, is solely that of the operator of the pavement/ramp.

7 Operating the trolleys

Pay attention to ensure that the trolley does not roll away. This may damage objects and injure people. Always hold onto the trolleys when using!

7.1 Extracting the trolleys

The trolleys may, according to the type provided, be extracted from the front or the rear of the line.

7.2 Using the trolleys

Standard model

- Only use the trolley on flat surfaces
- Only push the trolley at a walking pace
- Always hold onto the trolley

Moving pavement/ramp model

- Only push the trolley at a walking pace
- Always hold onto the trolley

7.3 Returning the trolleys

- Push the trolley at normal speed into the line and into the last trolley
- For trolleys with coin deposit systems, insert the key of the front trolley into the box of the one joining the line and remove the coin from the ejecting coin slot

8 Collecting and moving the trolleys

8.1 Manually collecting and moving

Caution! Long lines are difficult to manoeuvre and hard to brake. This may lead to damage to the store furnishings, of equipment and customer vehicles in the car park and injury to people.

We recommend two people to move trolley lines. One member of staff at the front of the line, one at the rear. The member of staff at the front must walk at the side in order not to fall over the platform and to prevent injury.

Trolleys for moving pavements/ramps should always be pushed individually over such.

The trolleys may be collected up, assembled into a line or decoupled from an existing line.

The trolleys are pushed to the required position with one member of staff at the end of the line and one at the front to steer and brake.

8.2 Collecting and moving with the assistance of machines and aids

Collection and moving may only be carried out in accordance with the instructions of the machine or device manufacturer.

9 Maintenance and inspection of trolleys

9.1 Cleaning the trolleys

Do not use scouring agents or aggressive cleaning agents.

Our products are protected by the new specially developed micro-diffusion impregnation ZINCMICRO® which has special properties with regard to corrosion protection. To clean and care for this surface, we recommend the use of the "Geck Intensive Trolley Cleaner" only.

In products impregnated with the micro-diffusion impregnation LPO Zincmicro®, the adherence of soiling particles is made more difficult. As a result, and with the sole use of our cleaner, the cleaning intervals are extended and the protective coating of the Zincmicro coat is maintained or improved. For this reason, simple cleaning with a pressure cleaner is sufficient.

However, attention should be paid the ingress of spray as a result of jets is directed immediately onto the connecting elements, mechanical parts or damaged parts, as this may lead to the formation of rust inside the tubes. For this reason, only a light spray of the trolleys is recommended.

In order to support the unusual corrosion protection properties of the impregnation as compared to traditional products and to prevent a one-sided wearing of our products, it is recommended that the selected parking location is in a protected location (with a roof if possible) and that the rear trolleys be swapped for the front trolleys from time to time. This will ensure a more evenly distributed use.

9.2 Inspecting the trolleys

Carry out regular daily visual checks and have damaged trolleys repaired or removed from use.

At least twice a year, carry out a comprehensive inspection of all trolleys. We recommend recording these inspections in a control book. Our check list may help you.

Checks:

- Check the trolley according to the following descriptions.
- In the event of deviations, faults or defects, the trolleys must be repaired, cleaned or disposed of accordingly.

<p>Checking the castors</p>	<ul style="list-style-type: none"> <input type="checkbox"/> Check for even floor contact of the castors <input type="checkbox"/> Check that the castors move freely <input type="checkbox"/> Check the directional stability <input type="checkbox"/> Check the safe attachment of the castors <input type="checkbox"/> Check for wear and damages <input type="checkbox"/> Check for contamination such as chewing gum and remove any dirt <input type="checkbox"/> Check the moving pavement/ramp castors for secure latching onto the pavement/ramp
<p>Visual check of the chassis, bumpers, repulsion rings, handle bars, handles and wooden platforms</p>	<ul style="list-style-type: none"> <input type="checkbox"/> Check for deformation, breaks or damages <input type="checkbox"/> Check for breaks and loose, sticking out wires <input type="checkbox"/> Check for secure attachment <input type="checkbox"/> Check for functionality <input type="checkbox"/> Check for wear

10 Applied norms

DIN 8472-1 – Requirements and checks for shopping trolleys with or without a child seat

11 Appendix

11.1 Checklist

Control – Checklist for Geck trolleys

Please check the trolleys twice a year

These checks must be carried out!

Inspection report

(Day of inspection)

(Company of inspector)

■ Check of the trolley for damages

Faults:

☐ Deformation on base frame or platform

☐ Breakage of welds or components

☐ Safe attachment of the castors

■ Checking of the function and the state of the trolley

☐ Can they be slotted into one another

☐ Handle

☐ Coin deposit system

☐ Bumper

☐ Wooden platform

■ Checking the castors

☐ Check castors for damage or wear

☐ Check washer discs are free from damage and blockages
(stones, threads, etc.)

☐ Contamination (by threads, chewing gum, etc.)

(Name of inspector)

(Signature of inspector)

Copy this page and file with the test protocols after checks!

12 Assembly, disassembly, replacing of parts

Caution!

Please only use Geck replacement parts!

Do not use third-party parts - speak to Geck!

12.1 Replacing the steering castors

Attachment with micro encapsulated hexagonal socket-type screw



12.2 Replacing the fixed castors

Attachment with self-tapping nut.



12.2.1 Lockable castors

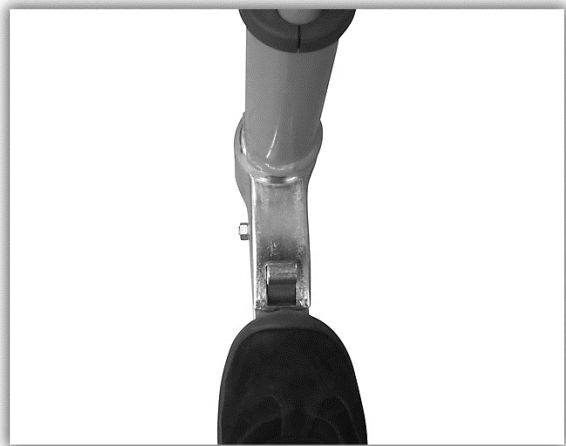

For releasing move the upper lever in travel direction. For locking move the pedal downwards.

12.3 Replacing the handle

Undo the screws on the tubes and remove the handle.

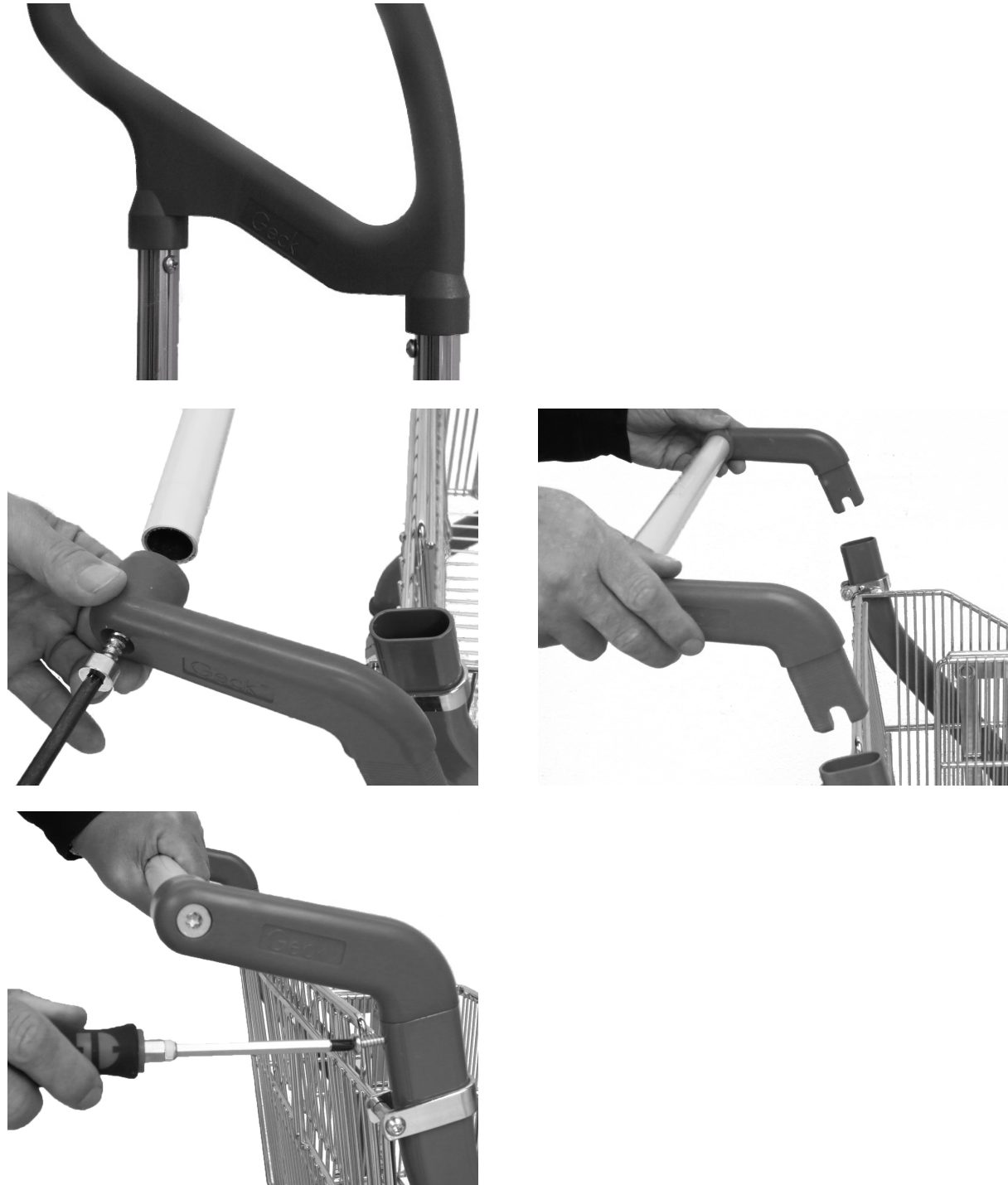

12.4 Replacing the lock

Undo the screws on both sides using a star hexagonal socket screwdriver and remove the handle with the handle caps.

Slide the new lock onto the handle tube. Insert the two handle cap elements into one another

Affix the caps to the sides of the handle. Secure the lock with the screw.

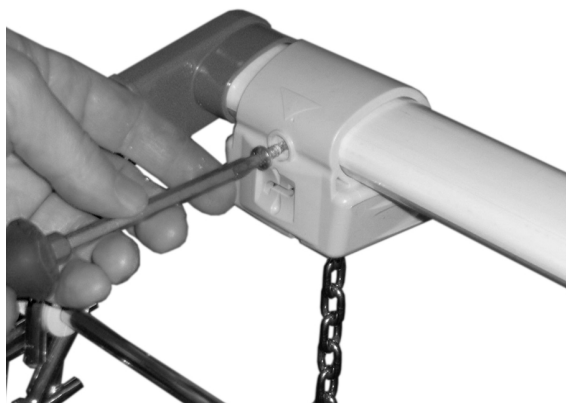
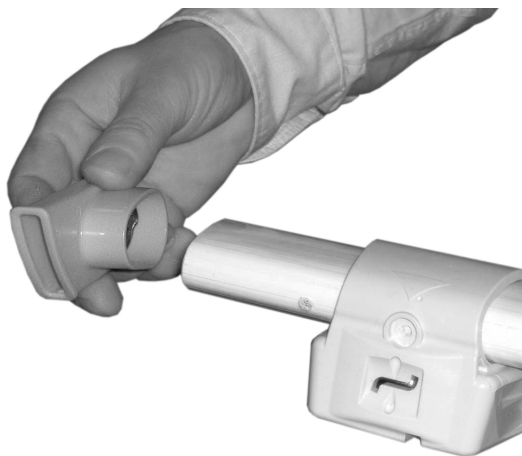

Coin deposit system:

Please only remove or replace after consulting the manufacturer.

11.4 Replacing the rack

Undo the hexagonal socket-type screws under the trolley, remove the screws and spacers. Remove the rack, insert a new rack and use the spacers and screws to secure again.



12.6 Replacing the bumper

Tip the trolley backwards towards the handle and lift the bumper using a tool. Put a new bumper into position and press into place.



12.7 Replacing in general

Replacements may only be carried out by service partners authorised by Geck.

13 Disposal

- Disassemble the trolley into its constituent parts.
- Sort the components according to materials and dispose of them in an environmentally friendly way.
- Observe the national directives and local regulations on waste disposal

Important information

Geck®

regarding handling returns

J.D. Geck GmbH

To whom it may concern,

In order to make sure that your returns are simply and quickly handled, please pay attention to the following points

- ✓ Fill out the enclosed print-out and send it back to us by fax.
- ✓ You will directly receive a returns number from us. Please identify the return dispatch clearly and legibly.
- ✓ Please specify the reason for the return.
- ✓ As soon as the goods with a justifiable complaint and packed in the original packaging are returned to us, we will immediately issue a credit or a replacement delivery.

If the return is based on an incorrect order, we must charge a processing fee to the tune of 20% of the net value of the goods, but at least 45.00 euros.

Please understand that we are not able to accept returned goods without a return number and reason.

We look forward to continuing working with you!

Your Geck service team

Return registration

Geck®

J.D. Geck GmbH

Mrs.

Jana Wistrich

Fax: +49 2352 542 30 123

To whom it may concern,

As a customer-oriented company, we offer you our returns service for fast and uncomplicated handling.

In order to guarantee the fastest-possible processing of your returns, we ask you to include a copy of the delivery note with this registration. The document should clearly show the number and the item number of the goods to be returned.

Please understand that we are not able to accept returned goods without the specification of a return number and reason.

Best regards from Altena

Your Geck GmbH

Delivery note number

Company name

Street

Postcode, Town/City

Contact person, Date, Signed

Telephone number

Reason for returning:

- ☐ Incorrect amount
- ☐ Incorrect item
- ☐ Quality fault
- ☐ Transportation damage
- ☐ Delivery date not met
- ☐ Others _____



Comments regarding your returns

This image shows a blank sheet of white paper with horizontal ruling lines. The lines are evenly spaced and extend across the width of the page. There are no margins, text, or other markings on the paper.

Geck®

Here is space for your notes



J.D. Geck GmbH • Grünewiese 28 • D-58762 Altena

Telephone: +49 2352 542 0 Fax: +49 2352 542 138

Email: info@geck.de Internet: www.geck.de

The copyright for this manual is held by J.D. Geck GmbH.

Our worldwide service for you

Geck Scandinavia Aps

Middelfartvej 63 G
Assenbolle Erhvervspark
5492 Vissenbjerg
Denmark
Tel: +45 70 25 2537
Fax: +45 70 272538
E-Mail: geck@geck.dk – www.geck.dk

Geck France EURL

10 rue de la Roseraie
67300 Schiltigheim
France
Tel: +33 60 11 71521
Fax: +33 38 88 11688
E-Mail: waechter@geck.fr – www.geck.fr

Foxbarn Ltd.

Unit 8, Towers Business Park
Carey Way, Wembley
Middlesex HA 9 0 LQ
United Kingdom
Tel: +44 20 87 95 6868
Fax: +44 20 89 02 1066
E-Mail: display@foxbarn.co.uk
www.foxbarn.co.uk

Instalaciones Madrid Display, S.L.

C/Bronce, 9
Pol. Ind. Campo Nuevo
28863 Cobeña (Madrid)
España
Tel: +34 91 620 8081
Fax: +34 91 620 9323
E-Mail: info@im-geck.com
www.im-geck.com